



The comprehensive inspection solution offering versatility, value, and flexibility

**FleXinspect T**



## Complete cold end inspection

**A total inspection solution** The FleXinspect T gives glass manufacturers a total inspection solution, as the fully equipped system is capable of providing all the necessary cold end inspections. The unique design of the servo-driven handling devices allows inspections that in the past were not possible with rotary inspection machines.

### Standard inspections

- Vision plug
- Vision ring
- Vision dip/saddle
- Check inspection with modulated lights and sensors
- Heel dot code mold number for defect correlation

### Additional inspections

- Mechanical plug/ring
- Mechanical dip/saddle
- Base/Base stress
- Sidewall opaque/Sidewall stress
- Sealing surface/Wire edge
- Bottom mold code reader (alpha dots)
- Wall thickness measurement (chromatic light)
- Non-contact 2 point out of round (ovality)
- Dimensional (lean, height, diameters)
- Tramp glass
- Vision check

### Container range and speed

The FleXinspect T inspects round and non-round containers with heights from 38 mm (21 mm minimum shoulder height) to 381 mm and diameters from 16 mm to 170 mm. The FleXinspect T is designed to operate at speeds up to 400 BPM depending on container shape and size.



## FleXinspect T

- Reduced line space and maintenance
- Higher speeds and larger ware
- Precise container rotation
- Non-contact vision gauging (plug, ring, dip)

A reliable and uniquely configurable platform that easily allows additional inspection functionality and redundancy as needed. The FleXinspect T provides unmatched modular versatility, value, and flexibility for glassmakers' current and future requirements.

As a component of the FleXinspect family, the FleXinspect T can be used in concert with the FleXinspect BC to create the most comprehensive inspection solution in today's market.



## Features

### Reduced line space and maintenance

- Multi-function configurations reduce the total number of machines per inspection leg
- High speed machinery reduces the number of inspection legs per forming line
- Significant maintenance and labor savings due to fewer inspection machines in the production area

### Higher speeds and larger ware

- New starwheel design allows for higher speeds on large diameter containers
- Flexible starwheel pocket configurations to maximize throughput (BPM)
- Synchronized servo technologies to optimize overall machine efficiency



### 840mm servo driven starwheel

Configured with 9/12/18/24/30/36 inspection pockets

- Up to 79mm dia. in 24 pocket with 12 stations
- Up to 107mm dia. in 18 pocket with 10 stations
- Up to 152mm dia. in 12 pocket with 7 stations
- Up to 160mm dia. in 9 pocket with 5 stations

### Non contact vision gauging (plug, ring, dip)

- Elimination of possible contamination or damage to the finish
- High speed operation with improved accuracy
- Simple and quick setup

### Precise container rotation

- Servo driven rotator with modular design for improved operation
- Servo technologies providing rotation performance feedback
- Modular design allows maximum setup flexibility



Innovative graphically designed user setup screen



Upper sidewall setup screen



FlexInspect T provides a new statistical based user interface

# Specifications

## Power requirements

380 to 480 VAC, 3 Phase, 25 Amps

NOTE: Transformer required for any other voltage.

## Air requirements

Minimum 3.5 bar nominal [50 psi]

Maximum 0.8 to 0.85 m<sup>3</sup>/minute

## Environmental considerations

Temperature maximum 50 °C [122 °F]

Relative humidity Max. 95% relative humidity (non-condensing)

## Machine speed

Maximum of 400 bpm

Minimum of 60 bpm

(Speed is affected by container dimensions, shape, starwheel configuration, and plug penetration)

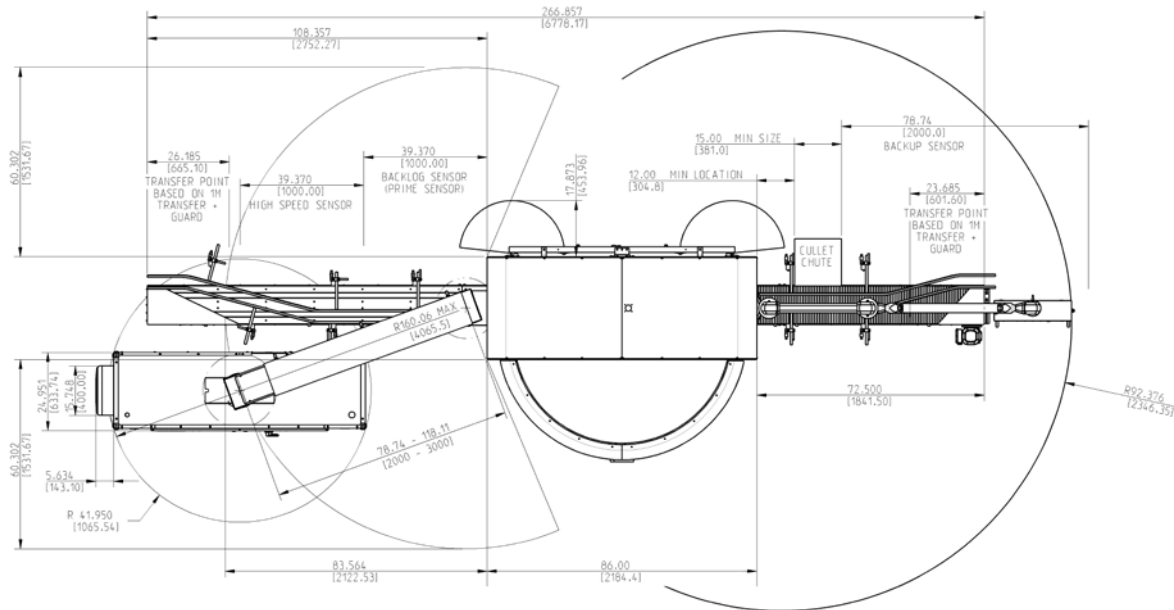

Specifications are subject to change. Actual performance depends on specific application, container size, and line speed. Dimensions represent nominal machine size and are not for installation purposes.

## Emhart Glass Worldwide Presence

Principal  
Emhart Glass SA  
Hinterbergstrasse 22  
CH-6330 Cham, Switzerland  
Tel. +41 41 749 42 00 Fax +41 41 749 42 71

## Leipzig Germany

Tel. +49 341 250773 20 Fax +49 341 250773 21

## Savona Italy

Tel. +39 019 51 66 1 Fax +39 019 51 66 301

## Kawasaki Japan

Tel. +81 44 222 7371 Fax +81 44 222 4868

## Johor Bahru Malaysia

Tel. +607 863 1122 Fax +607 863 7717

## Singapore

Tel. +65 6778 1466 Fax +65 6778 9433

## Örebro Sweden

Tel. +46 19 307 500 Fax +46 19 307 501

## Sundsvall Sweden

Tel. +46 60 199 100 Fax +46 60 199 261

## St. Petersburg FL USA

Tel. +1 727 471 1113 Fax +1 727 471 1290

## Elmira NY USA

Tel. +1 607 735 2600 Fax +1 607 735 2601

## Windsor CT USA

Tel. +1 860 298 7340 Fax +1 860 298 7395

## Owensville MO USA

Tel. +1 573 437 2132 Fax +1 573 437 3146

## Perrysburg OH USA

Tel. +1 567 336 7733 Fax +1 567 336 8727